



.22LR Conversion and Sear Trip Kit Instructions

Instruction Manual for recommended installation of the FosTecH .22LR conversion kit with FosTecH sear trip kit for use with FosTecH Echo Triggers. The .22LR conversion kit is designed to replace the bolt carrier group for a .223/5.56 AR 15 upper.

The recommended setup for the .22 Kit utilizes the Extra Power Recoil Spring, the Caliber Conversion Hammer Spring (with the Echo AR-II) and the FosTecH modified Sear Trip Kit with Anti-Bounce Weight. If results aren't consistent, see section entitled "Tips for Further Tuning".

Included with your .22 LR Conversion Kit:

- A) .22 Conversion Bolt Assembly
- B) Factory Recoil Spring
- C) Recoil Spring Guide Rod
- D) Hammer Resetting Lug
- E) Extra Power Recoil Spring
- F) Chamber Insert
- G) Chamber Insert Cover
- H) Bolt Assembly Guide Rod Shaft

Included with your Sear Trip Kit:

- I) Auto Sear Trip
- J) Shortened Trigger Lock Spring (for use with AR-II Trigger)
- K) Anti-Bounce Weight
- L) Full-Length Trigger Lock Spring (for use with AR-II Trigger)
- M) Caliber Conversion Hammer Spring (for use with AR-II Trigger)

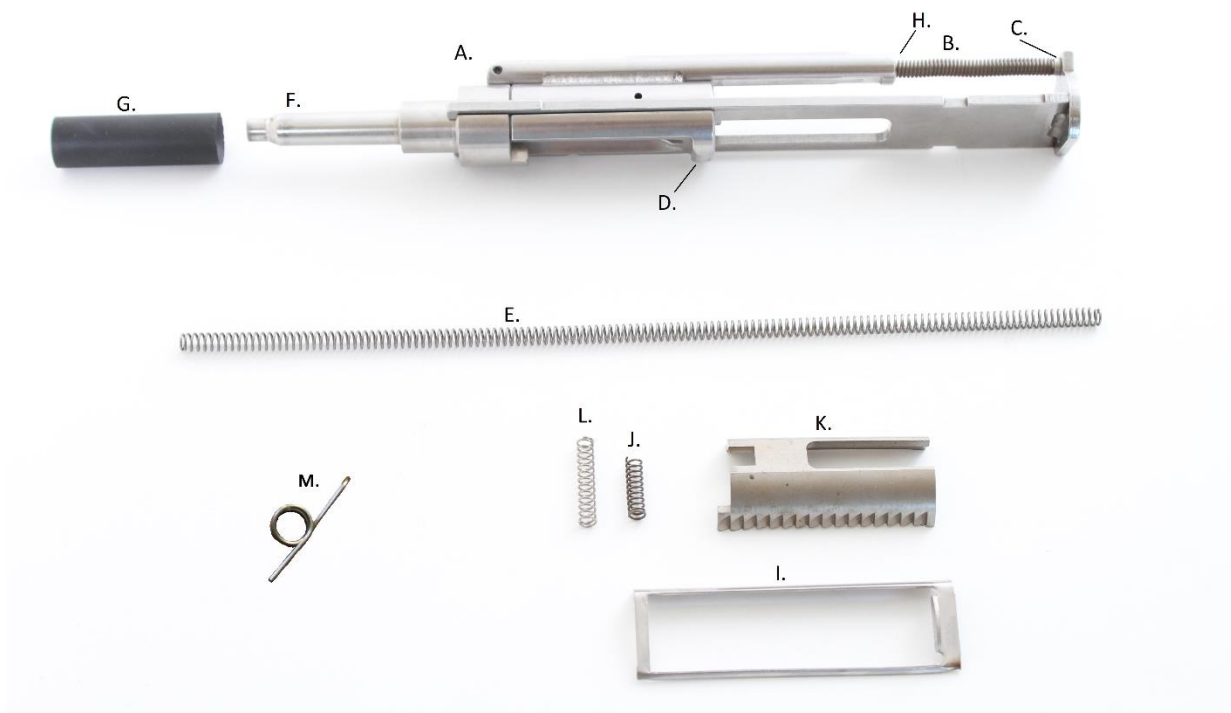

Instructions:

1. Preparing the .22 Conversion Bolt Assembly (Replacing the Recoil Spring)

- a. Open the container housing your .22LR conversion kit, and carefully lay the included parts on the table.
- b. Carefully pull back on the Recoil Spring Guide Rod (C). (Figure 1)
- c. Lift up on the Recoil Spring (B) and Guide Rod (C), and Pull it out of the Bolt Assembly (A). (Figure 2)
- d. Remove the Factory Recoil Spring (B), from the Guide Rod (C).
- e. Slide the Extra Power Recoil Spring (E) onto the Guide Rod (C).
- f. Carefully pull back on the Extra Power Recoil Spring (E), and reinsert Guide Rod (C) into the Bolt Assembly (A).
- g. Remove the Chamber Insert Cover (G).

Fig.1



Fig. 2



Fig. 3

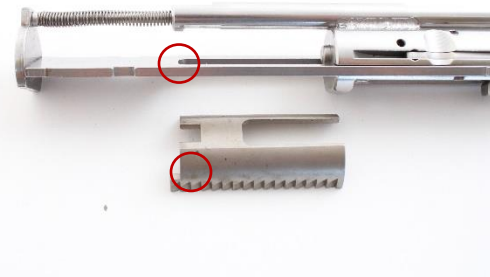

Fig. 4



Fig. 5



Fig. 6



2. Installing the Sear Trip Kit

- a. Place the Anti-Bounce Weight (K) tight against the Bolt Assembly (A) underneath the Recoil Spring Guide Rod (C).
 - The notch on the Anti-Bounce Weight (K) should line up with the "step" on the Bolt Assembly Guide Rod Shaft (H). (Figures 3 and 4)
 - The serrations for the Forward Assist should be on the right side of the assembly.
 - You will need to hold the Anti-Bounce Weight (K) in place while you install the Auto Sear Trip (I). (Figure 5)
- b. Holding the Anti-Bounce Weight (K) in place with your thumb and index finger, turn the Bolt Assembly (A) over, revealing the Hammer Resetting Lug (D). (Figure 6)

- c. Lay the Auto Sear Trip (I) so that the front of it is in front of the Hammer Resetting Lug (D), and the rearward tab is pointing up (since the Bolt assembly is currently upside down) and toward the rear of the assembly. (Figure 7)
 - These instructions take for granted that your Sear Trip Kit was purchased from FosTech, and not from CMMG directly.
 - If the Sear Trip Kit was purchased from CMMG, then the two small tabs on either side of the sear trip tab will need to be carefully removed leaving the sear trip tab intact. (Figure 8)
- d. Hold the Auto Sear Trip (I) and Anti-Bounce Weight (K) carefully, so that they stay in position while you flip the assembly back over and insert it into your upper receiver. (with bolt carrier removed). Ensure that your charging handle is in its correct position. (Figure 9)



Fig. 9



3. Installing the Caliber Conversion Hammer Spring (For Echo AR-II ONLY)

- Remove the Echo AR-II Trigger from your lower receiver and follow the included instructions entitled “Caliber Conversion Hammer Spring Installation”.

4. Mating your upper with .22LR Conversion and Sear Trip Kit installed.

- This procedure is the same as the mating procedure described in the Echo instruction manual with some additional steps to account for the Auto Sear Trip (I) (photos show the Echo AR-II, but instructions apply to the Sport also.)

- a. Push in the front pivot pin, attaching your upper receiver to your lower receiver.
- b. With the front of the barrel resting on a table, lay the firearm to one side, holding firmly to the pistol grip. (Figure 11)
- c. With the upper receiver on its side, slide the Auto Sear Trip (I) back as far as it will go. (The tab needs to be

Fig. 11



Fig. 12



behind the trigger lock when the upper and lower are mated) (Figure 12)

- d. In **Echo Mode**, move the trigger lock forward. Pull and hold the trigger firmly. This will allow the hammer to fall.
- e. Continue to hold your trigger firmly in the pulled position, (this will keep your trigger lock forward).
- f. Carefully close your upper onto your lower without allowing the Auto Sear Trip (I) to fall forward in front of the trigger lock. (Figure 13)
- g. You will now be able to push your rear pin through and complete your AR-15 with .22LR conversion kit.

Fig. 13



Tips for Further Tuning

1. **Remove the Anti-Bounce Weight (K)** – Sometimes the Anti-Bounce Weight (K) will prevent the Auto Sear Trip (I) to overcome the Trigger Lock Spring (J). Removing it might provide more consistency.
2. **Install the Shortened Trigger Lock Spring (AR-II only)**
 - Remove the Echo AR-II Trigger from your lower receiver and reinstall, following the instructions in your Echo AR-II instruction manual, using the shortened Trigger Lock Spring (J) in place of your factory, full length Trigger Lock Spring (L). (Figure 10)
 - If you do not have consistent results with your echo trigger, using the shortened trigger lock spring, you may need to “tune” your Echo, by methodically clipping one loop at a time off your Full-Length Trigger Lock Spring (L), and trying it, until you achieve consistent results.
3. **Ensure the upper, the conversion kit, and the magazine are cleaned and lubricated properly.**

.22 is notoriously dirty and can cause your system to malfunction if not cleaned thoroughly and regularly.
4. **Try different ammo, as different loads and brands will produce different results.**

Fig. 10





Caliber Conversion Hammer Spring Installation

For Echo AR2 Triggers Only

Video intructions available at www.echoquestions.com

1. Carefully remove Hiperfire assembly.



2. Using the Hiperfire toggle retainer, push the hammer sleeve through, so that the clip-end of the sleeve is pushed through first.



3. Remove the stock hammer spring by carefully pulling out the legs and sliding it off the hammer. (Note: The caliber conversion hammer spring has straight legs, making it easy to distinguish the new spring from the stock spring.)



4. Install the caliber conversion hammer spring by carefully pulling on the legs and sliding down over the hole closest to the bottom of the hammer.



5. Set the hammer sleeve on your table so that the clip-end is face down.



6. Position the hammer inside the case and push against the spring pressure until the sleeve holes in the hammer and case line up. (This will take some strength) Then insert the sleeve by pushing the trigger pack onto it. Using the table enables you to use both hands to keep the sleeve holes in the hammer and case lined up. Ensure the sleeve is flush with the case.



7. Reassemble Hiperfire assembly. For detailed instructions on reassembly of the Hiperfire assembly, see the video entitled "Echo Trigger Reassembly Video" at www.echoquestions.com.

